

FORD SOCKET ASSY. & HARNESS CONNECTORS

Use with butt connectors on pages 137 - 149 • Illustrations Not Actual Size

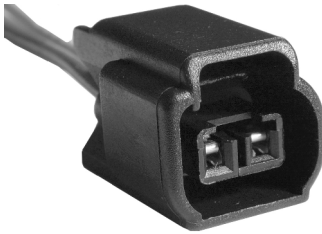

20845

(Not Supplied By O.E.M.)

Cam Shaft And Crank Shaft Sensors
Harness Connector
Two 18 Ga. Leads
Fits Sensors F0CZ-6B288-A,
F1AZ-6B288-A, F1AZ-6C315-A &
XC3Z-6B288-AA
Ford 1991 - On

UNIT PACKAGE: 1



20840

(Not Supplied By O.E.M.)

Glow Plug Pass Thru At Valve
Cover Gasket Harness Connector
Two 16 Ga. & Three
18 Ga. Wire Leads
Ford E350, F250-F550SD
& Excursion 7.3 Diesel
1996 - On

UNIT PACKAGE: 1

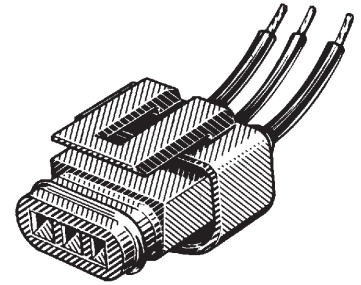

17659

(Not Supplied
By O.E.M.)

Voltage Regulator Plug
Harness Connector
Sable, Taurus, Tempo & Topaz
With Internal Voltage Regulator
1986-On

UNIT PACKAGE: 1

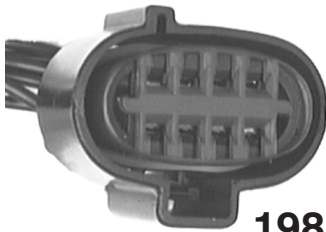

19880

(Not Supplied
By O.E.M.)

Transmission Gear Shift
Position Sensor Harness Connector
Eight Wire Leads
Used With Switch F5TZ-7A247 on
Ford Trucks w/ E 4 OD Transmission,
RWD 1989-84 and E, F & U Series
1989-On

UNIT PACKAGE: 1

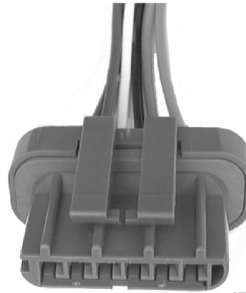

19885

(F4PZ-14A411C)

Windshield Wiper Motor
Harness Connector
For New Single Connector
Replacement Motors (6 Positions)
Ford 1987-On

UNIT PACKAGE: 1

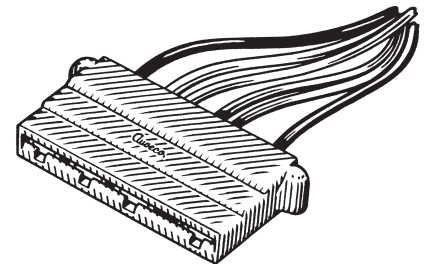

11445

Voltage Regulator
Harness Connector
Ford

UNIT PACKAGE: 10

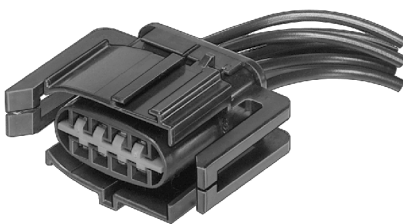

19004

(F2PZ-14A464C,
F4UB-14A464A)

Transmission MLP Sensor
Harness Connector
E150/350, F250/350
& U150 (Bronco)
1990-On

UNIT PACKAGE: 1



18668

(Not Supplied
By O.E.M.)

In-Tank Fuel Pump &
Sending Unit Connector
Ford 1985-On

UNIT PACKAGE: 5

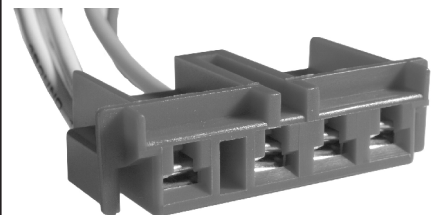

20850

(Not Supplied By O.E.M.)

Voltage Regulator
Harness Connector
Four 14 Ga. & Two 18 Ga.
Wire Leads
Fits Voltage Regulator
F0PZ-10316-A
Ford 1975 - On

UNIT PACKAGE: 10