

Sec. 1

TAPPING SCREWS

Listed According To Size

Pop On Polypropylene Screw Covers & Bases

They're simple to use:

1. Place washer over pilot or starting hole for screw, nail or rivet.
2. Install fastener.
3. Place Snap Cap over washer at slight angle.
4. Simply push Snap Cap down firmly.

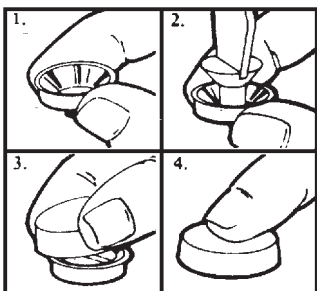

Covers



Auveco Part No.	Screw Size	Color	O.D.	Unit Pkg.
13831	#4	Black	1/2"	50
13832	#4	White	1/2"	50
13833	#6	Black	1/2"	50
13834	#6	White	1/2"	50
13835	#8	Black	5/8"	50
13836	#8	White	5/8"	50
13837	#10	Black	5/8"	50
13838	#10	White	5/8"	50

Bases



Auveco Part No.	Screw Size	Use with Cover	Unit Pkg.
13839	#4	13831 & 13832	50
13840	#6	13833 & 13834	50
13841	#8	13835 & 13836	50
13842	#10	13837 & 13838	50



Phillips Flat Head Tapping Screws

Size	Zinc Part No.	Unit Pkg.	Bk. Oxide Part No.	Unit Pkg.
4 x 1/4"	5646	100		
4 x 3/8"	5647	100	12899	100
4 x 1/2"	5648	100	12900	100
4 x 5/8"	5649	100		
4 x 3/4"	5650	100		
6 x 5/16" .4 Hd.	2736	100		
6 x 1/2" .4 Hd.	5651	100		
6 x 1/2"	1946	100	12801	100
6 x 5/8"	5653	100		
6 x 3/4" .4 Hd.	*2803	100		
6 x 3/4"		12802		100
6 x 1"		12803		100
* Chrome				
8 x 3/8"	5654	100		
8 x 7/16" .6 Hd.	1479	100		
8 x 1/2" .5 Hd.	1711	100		
8 x 1/2" .6 Hd.	2804	100	10173	100
8 x 1/2"	5655	100	10172	100
8 x 5/8" .6 Hd.	5656	100		
8 x 3/4" .6 Hd.	1712	100	10174	100
8 x 3/4"	2807	100	10175	100
8 x 1" .6 Hd.	5660	100	10176	100
8 x 1"	5661	100	10177	100
8 x 1-1/4" .6 Hd.			10178	100
8 x 1-1/4"			10179	100
8 x 1-1/2" .6 Hd.			12805	50
8 x 1-1/2"			12806	50
10 x 1/2"			12807	100
10 x 3/4"	2810	100	12809	100
10 x 1"	5672	100	12811	50

Slotted Oval Head Tapping Screws



Bright Zinc Chromate

Auveco Part No.	Size	Unit Pkg.	Auveco Part No.	Size	Unit Pkg.
1432	6 x 1/2"	100	5616	12 x 5/8"	100
1144	6 x 5/8"	100	3483	12 x 7/8"	100
1148	8 x 5/8"	100	2457	12 x 1"	100
1149	8 x 3/4"	100	5617	14 x 5/8"	100
1137	8 x 1"	100	5618	14 x 2-1/4"	100
1091	10 x 3/4"	100			
1450	10 x 1-1/2"	100			