

STAINLESS STEEL

18-8 (300 SERIES)

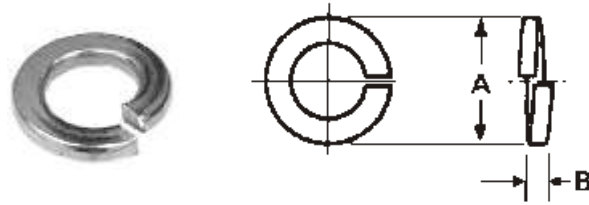

Stainless Steel Medium Split Washers

Auveco Part No.	Size	O.D. (A)	Minimum Thickness (B)	Unit Pkg.
13400	No. 6 or 1/8"	1/4"	.031	100
13401	No. 8	19/64"	.040	100
13402	No. 10 or 3/16"	21/64"	.047	100
13403	1/4"	31/64"	.062	100
13404	5/16"	19/32"	.078	100
13405	3/8"	11/16"	.094	100
13406	1/2"	7/8"	.125	50

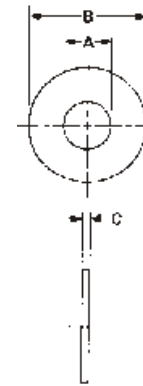

Stainless Steel Commercial Flat Washers

Auveco Part No.	Bolt Size	I.D. (A)	O.D. (B)	Approximate Thickness (C)	Unit Pkg.
13392	No. 6 or 1/8"	9/64"	3/8"	.030	100
13393	No. 8	5/32"	3/8"	.030	100
13394	No. 10 or 3/16"	7/32"	7/16"	.030	100
13395	1/4"	9/32"	5/8"	.043	100
13396	5/16"	11/32"	3/4"	.050	100
13397	3/8"	13/32"	7/8"	.060	50
13398	1/2"	33/64"	1-1/4"	.060	50